

Date Saved: 02/03/2021

Document Path: \\uk.wspgroup.com\central\_data\Projects\70072090 - Beaulieu Substation\03 WIP\EAM\GIS\MXD\Consultation\Fig 2b - Proposed Development showing red line site boundary and site layout.mxd

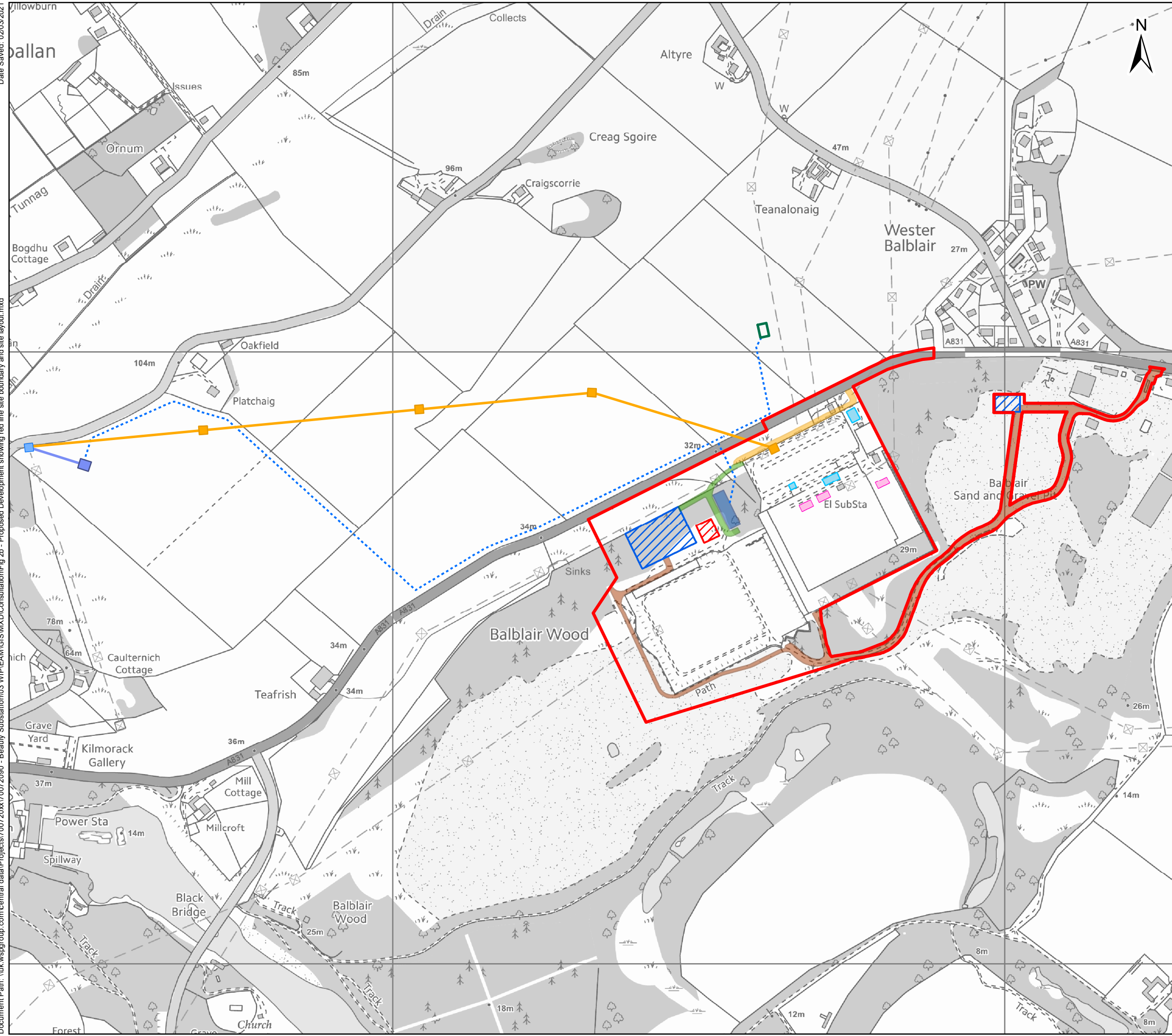

### Legend

- Pre-Application Notice (PAN) Red Line Boundary
- Proposed Underground Cable
- Proposed 132kV Overhead Line
- 132kV Overhead Line to be Decommissioned
- Electricity Tower to be Decommissioned
- Existing Tower
- Proposed 132kV GIS building
- Proposed Area Allocated for Drainage (SUDS)
- Construction Compound and Laydown Area
- Proposed Permanent Access Track
- Proposed Buildings to be Demolished
- Proposed Construction Access (Permanent)
- Proposed Construction Access (Temporary)
- Replacement of Supergrid Transformers
- 132kV Tower with Cable Sealing End Platform
- Proposed Cable Joint

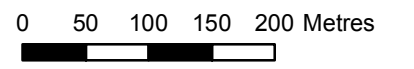

Client: Scottish & Southern Electricity Networks

Project: **Beaulieu 132kV Reinforcement**

Title: **Figure 2b Site Layout Plan**

Date: 02 March 2021      Scale: 6,000 @ A3  
 Drawn: LH      Checked: AK      Approved: JW  
 Drawing Number: 70072090-004