

NOTES

- DO NOT SCALE FROM THIS DRAWING MANUALLY OR ELECTRONICALLY.
- THIS DRAWING IS TO BE READ IN CONJUNCTION WITH ALL OTHER RELEVANT PROJECT INFORMATION.
- ALL DATUM LEVELS ARE IN METRES AND DIMENSIONS ARE IN METRES UNLESS OTHERWISE STATED.
- ALL SLOPES AND EMBANKMENTS SHOWN ON THIS DRAWING FALL OR RISE AT 1 IN 3.
- REFER TO DRAWING LT459-SWE-XX-XX-D-X-0002 AND 0003 FOR GENERAL SITE LAYOUT DETAILS.

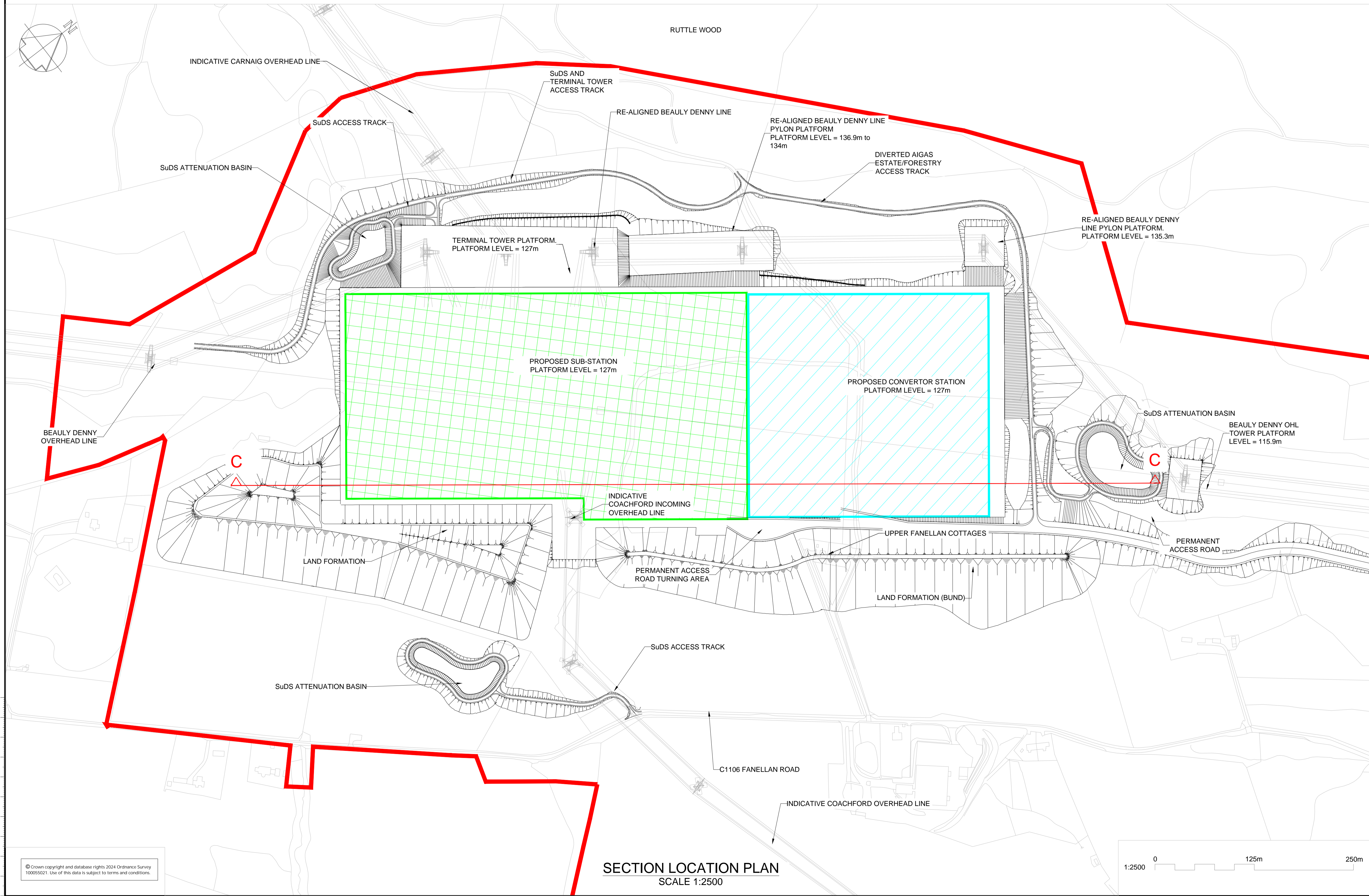
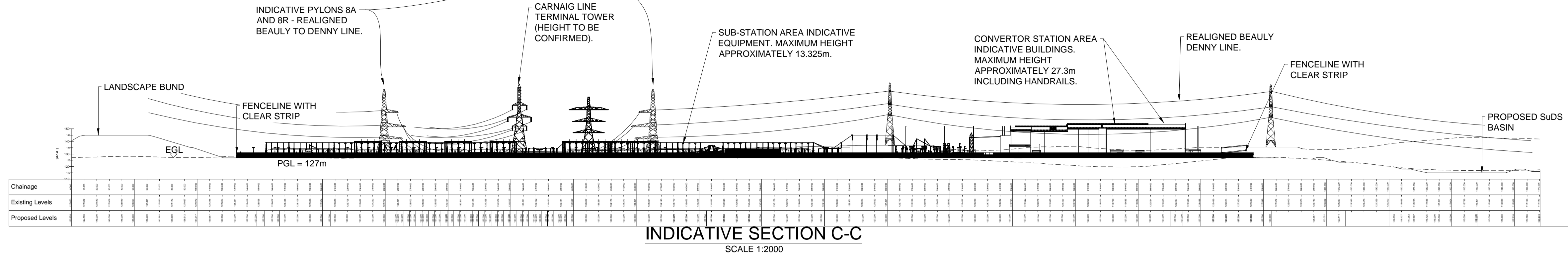

KEY TO DRAWING

- SITE RED LINE BOUNDARY
- PROPOSED GROUND LEVEL
- - - EXISTING GROUND LEVEL
- CONVERTOR STATION AREA
- SUB-STATION AREA

Rev	Date	Amendment Details	Dr'n	Chk'	App'
P06	10/02/2025	ACCESS ROADS UPDATED	RL	NG	CB
P05	28/11/2024	HEIGHTS UPDATED	RL	NG	CB
P04	09/09/2024	FINAL LAYOUT	RL	NG	CB
P03	19/04/2024	DESIGN FIX 2C	MA	RL	CB
P02	06/03/2024	DESIGN FIX B	NG	RL	CB
P01	30/10/2023	FOR COMMENT	MA	RL	CB

This drawing should not be relied on or used in circumstances other than those for which it was originally prepared and for which Sweco UK Limited was commissioned. Sweco UK Limited accepts no responsibility for this drawing to any party other than the person by whom it was commissioned. Any party which breaches the provisions of this disclaimer shall indemnify Sweco UK Limited for all loss or damage arising therefrom. COPYRIGHT © Sweco 2022

2nd Floor, Quay 2
139 Fountainbridge
Edinburgh
EH3 9QG
Tel: +44 (0)131 550 6300
Web: www.sweco.co.uk

SWECO



Client
**FANELLAN
400kV SWITCHING STATION AND
HVDC CONVERTOR STATION**

Project Title
**SITE GENERAL LAYOUT
SECTIONS
SHEET 2 OF 2**

Purpose Of Issue
PRELIMINARY

Status	Description
S5	FOR REVIEW AND ACCEPTANCE

Drawn	Designed	Checked	Approved
NG	NG	RL	CB

Sheet Size	Scale	Sweco Ref	Revision
A1	AS SHOWN	65209842	P06

Drawing Number
LT459-SWE-XX-XX-D-X-0113

© Crown copyright and database rights 2024 Ordnance Survey 100055021. Use of this data is subject to terms and conditions.